

Fort Missoula
MONTANA
1889

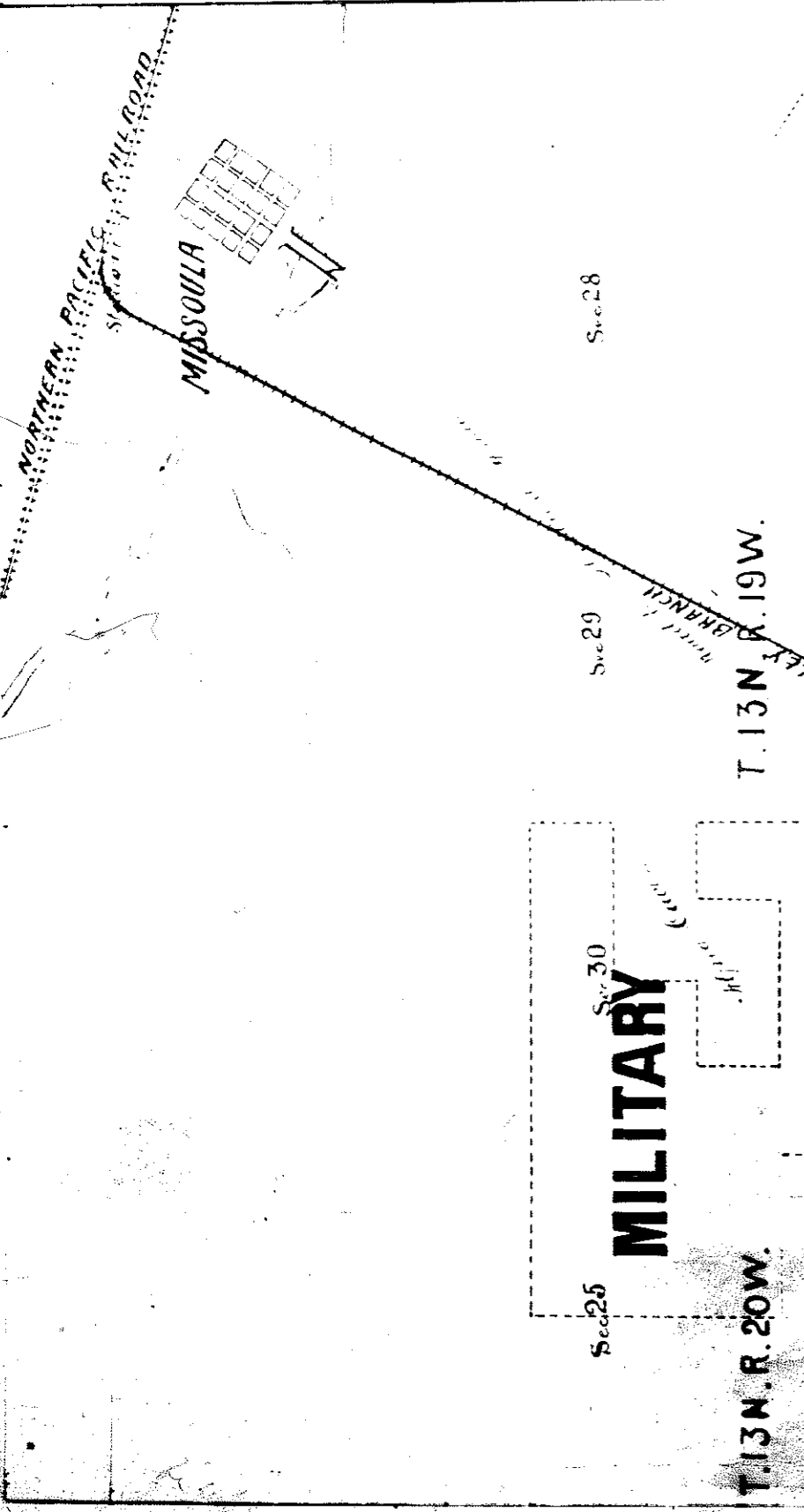

MILITARY RESERVATION

FORT MISSOULA



*Military Reservation
Fort Missoula*

Announced in G.O. No. 4 D.D. 1877
Enclosed in G.O. 107 D.D. 1879

Main portion of the Post proper is situated on School lands. Congress has been asked to add to the Mt. Reservation the East half of Sec. 30, T. 13 N. R. 20 W. Montana from Division

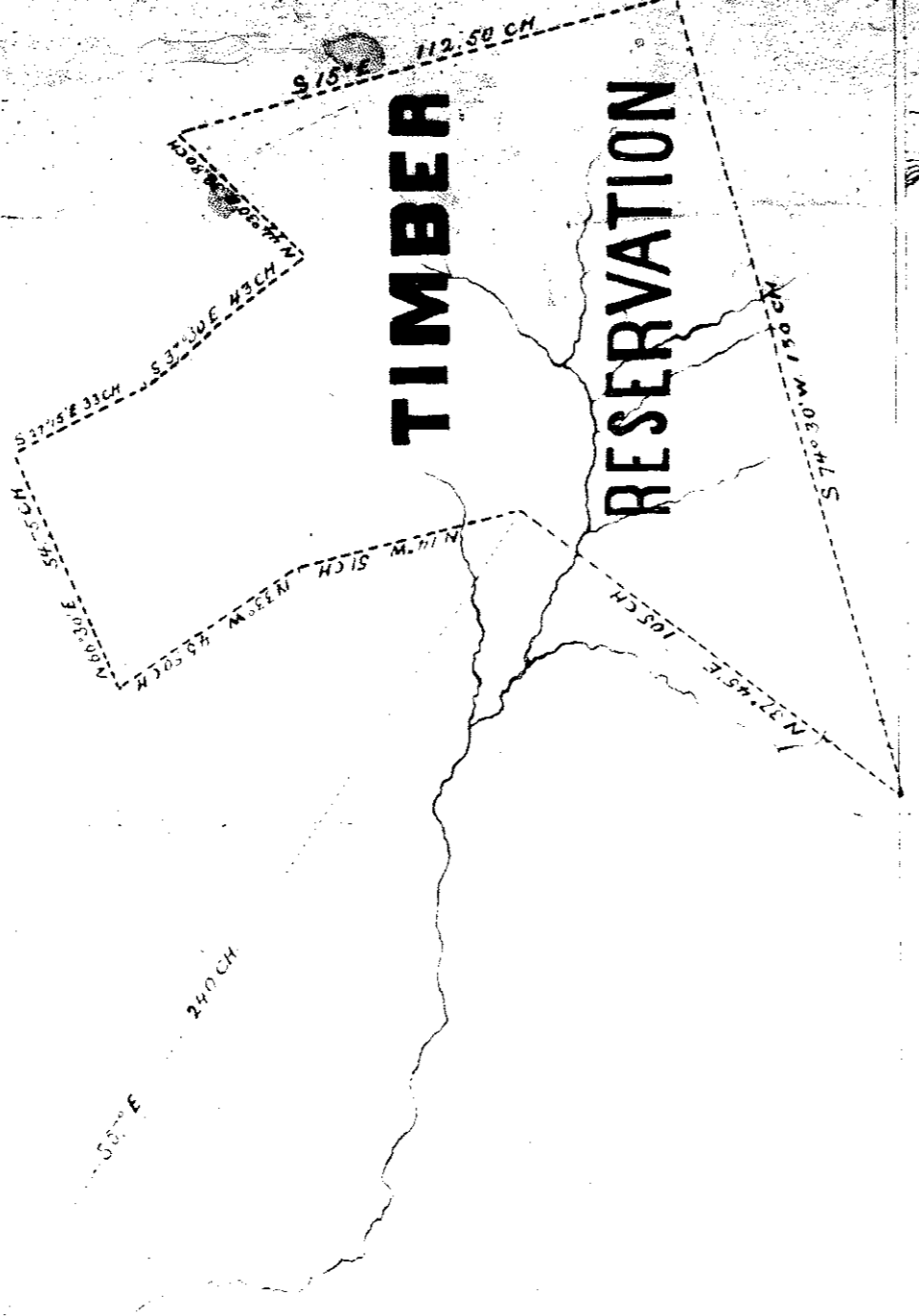

TIMBER RESERVATION

181 - ICE HOUSE

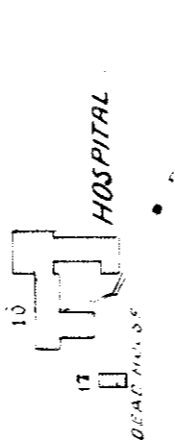

HOSPITAL

HOSPITAL STEW' QRS.



CHAPEL



BARRACKS

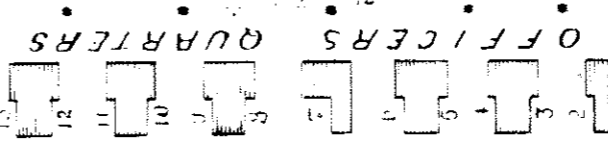

OFFICERS QUARTERS



A.C.S. QRS.



BAKERY

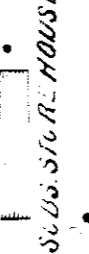

SUBS. STORE HOUSE

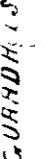

GUARD HOUSE



Q.M. STORE HOUSE



TERMSTERS QRS.



Q.M. STABLES



GRANARY

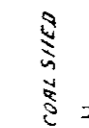

COAL SHED

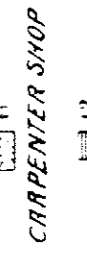

CARPENTER SHOP

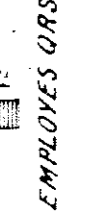

EMPLOYES QRS.



MAGAZINE

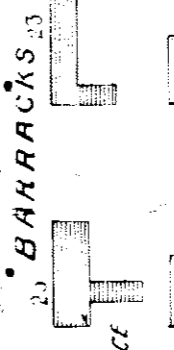

BARRACKS



OLD TRADERS



SAW MILL

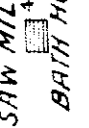

BATH HOUSE



ENGINEERS QRS.

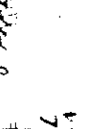

6 PARKE

BITTER ROOT RIVER